

# Assembly instructions Stand

## KERN FEJ-A05

Version 1.0  
2022-07  
GB



TFEJ-A05-A-IA-e-2210



# KERN FEJ-A05

Version 1.0 2022-07

## Assembly instructions Stand

---

---

### 1 Technical data

KERN	FEJ-A05
Stand height	70 cm

### 2 Scope of delivery



The 3 screws and washers of the terminal (see 3, no. [3]) are not supplied with the stand. They are included with the scale.

- Stand
- Cover for rotary knobs
- Cable clip
- 6 screws with washers (for the stand)
- 1 screw with washer (for the cable clamp)

### 3 Overview

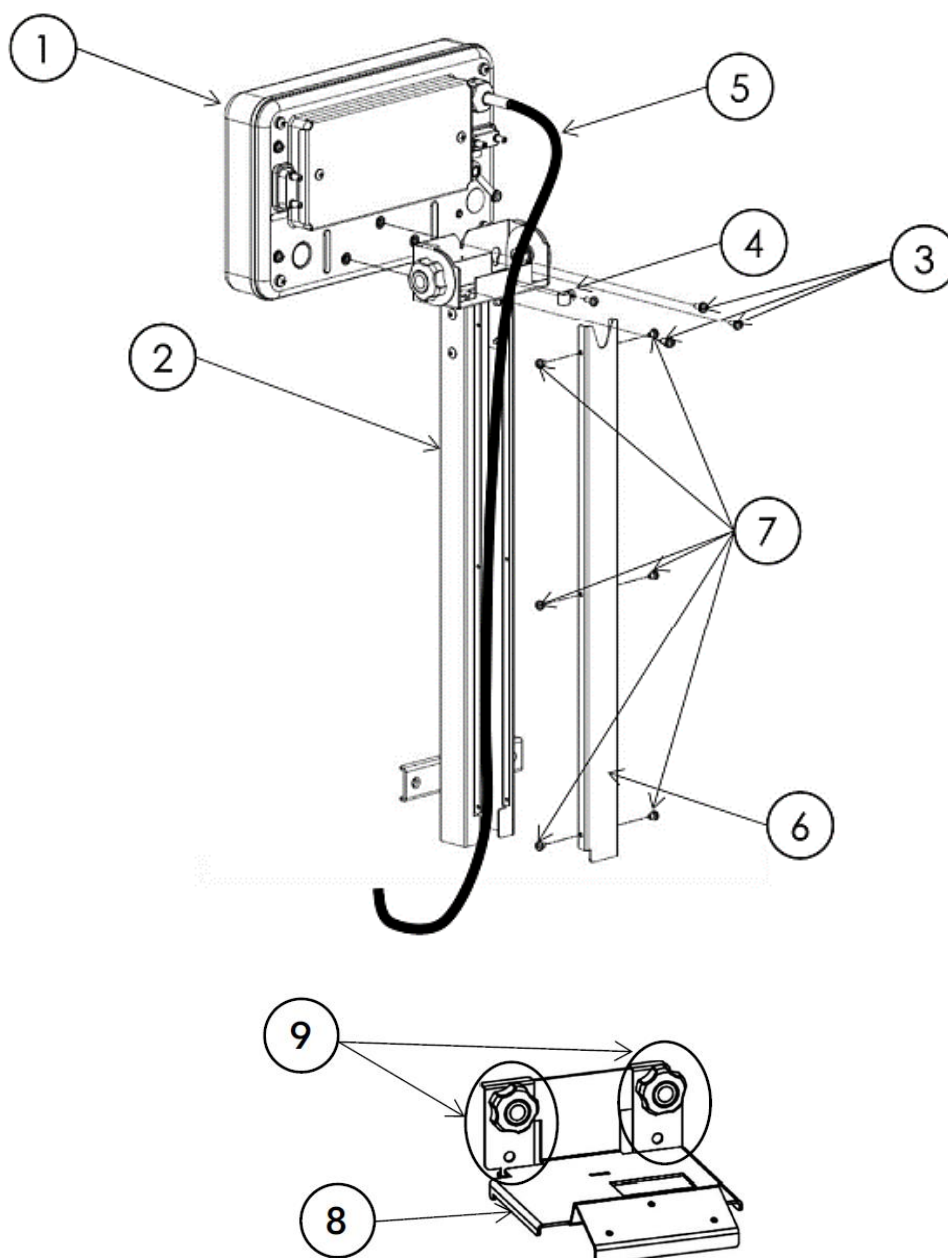

[No.]	Designation	[No.]	Designation
1	Terminal	6	Stand cover
2	Tripod	7	Screws with washers
3	Screws with washers	8	Wall bracket
4	Cable clamp with screw and washer	9	Turning knobs (wall bracket)
5	Scale cable		

## 4 Assembly



The assembly described refers to the scale and stand as delivered. If you have already mounted the scale with the terminal, for example, you must remove it again.

1. Remove the weighing plate from the scale.

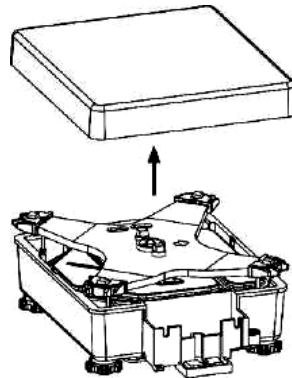

2. Loosen the 3 screws [3] on the back of the terminal [1].
3. Loosen the 6 screws [7] of the stand cover [6] and lead the scale cable [5] through the stand [2].
4. Guide the scale cable [5] through the cable clamp [4] and fasten the cable clamp on the back of the stand [2] with the screw.

**Make sure that the scale cable is not taut between the cable clamp and the terminal, but loose enough so that you can adjust the display angle of the terminal later.**

5. Reattach the stand cover [6] to the stand [2] with the screws [7].
6. Attach the terminal [1] to the stand [2] and fasten it with the 3 screws [3].

**Hint:**

- ⇒ Slightly screw the top screw with washer into the terminal before attaching the terminal to the stand.
- ⇒ Place the stand with the upper recess (A) on the screw of the terminal.
- ⇒ Slide the stand onto the terminal so that the holes of the terminal are congruent with the positions C of the stand.
- ⇒ Screw in the other screws with washers and tighten all 3 screws.

Make sure that the washers do not get under the recesses (A, B) of the stand.

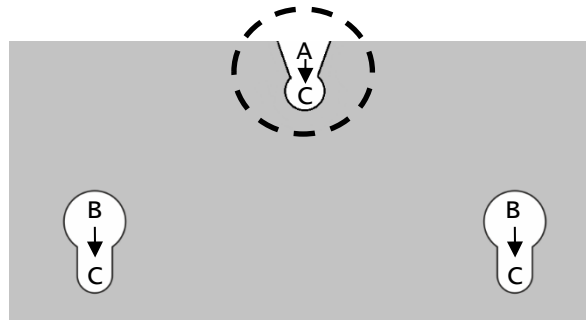

7. Insert the stand [2] into the cable compartment and make sure that the contact plate of the stand touches the inside of the cable compartment.

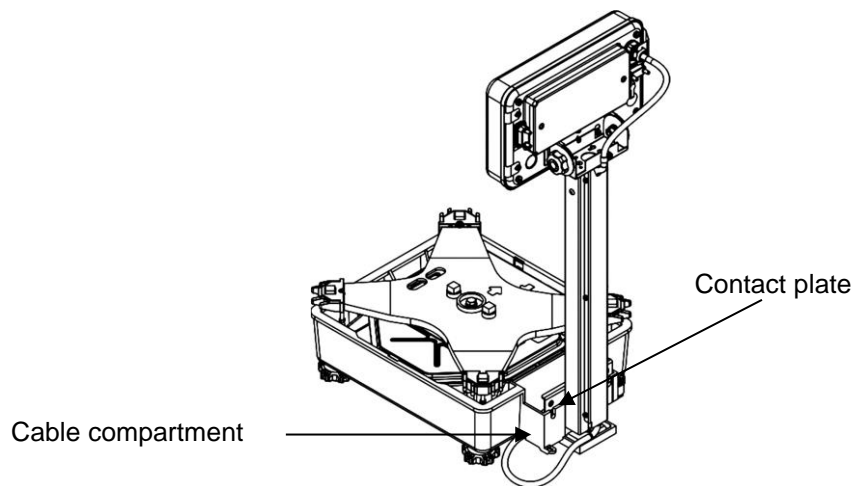

8. Pull the scale cable [5] through the lower recess of the stand [2].

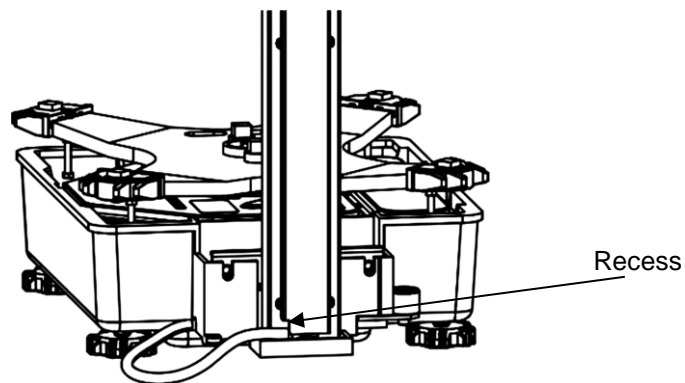

9. Remove the knobs [9] and mounting plates from the wall fixture [8].

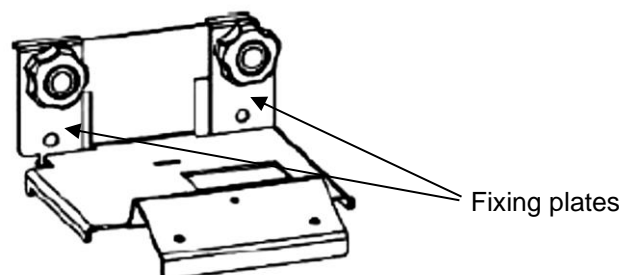

10. Hook the fastening plates onto the cable compartment and tighten them with the knobs [9] a little more than hand-tight.

**Make sure that the recesses of the fastening plates are aligned.**

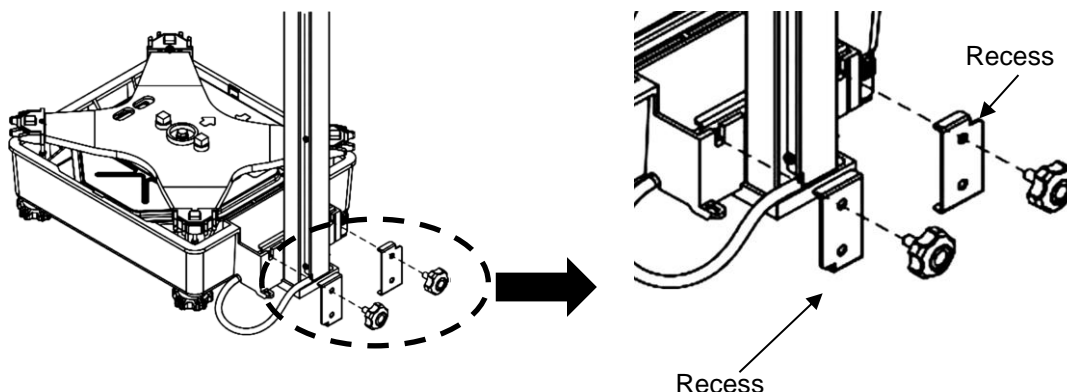

11. Loosely fold the protruding scale cable [5] and place it in the cable compartment of the scale.

**Make sure that the scale cable is not stretched or kinked so as to avoid damage.**

12. Apply the cable compartment cover from above, bending the sides slightly outwards.

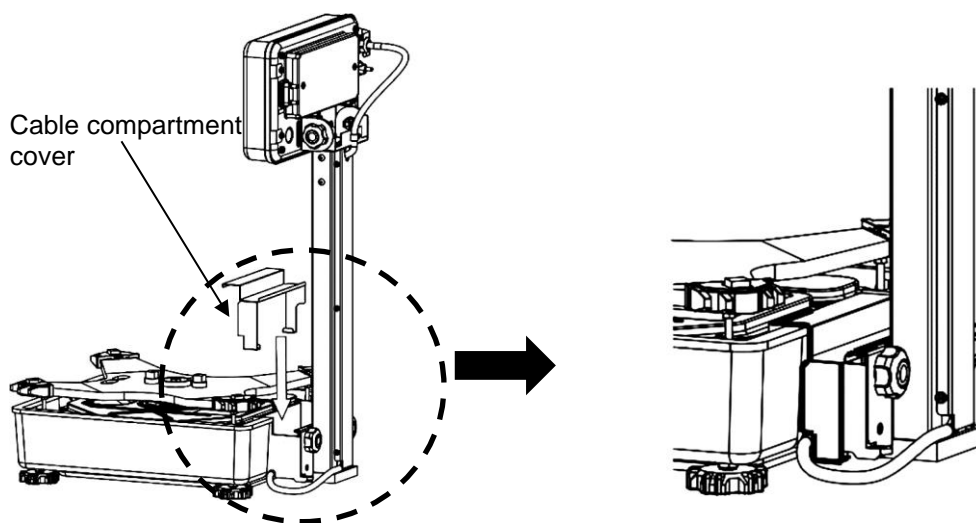

13. Insert the knob cover from above over the two knobs of the wall bracket. Lock in place using the recess on the wall bracket.

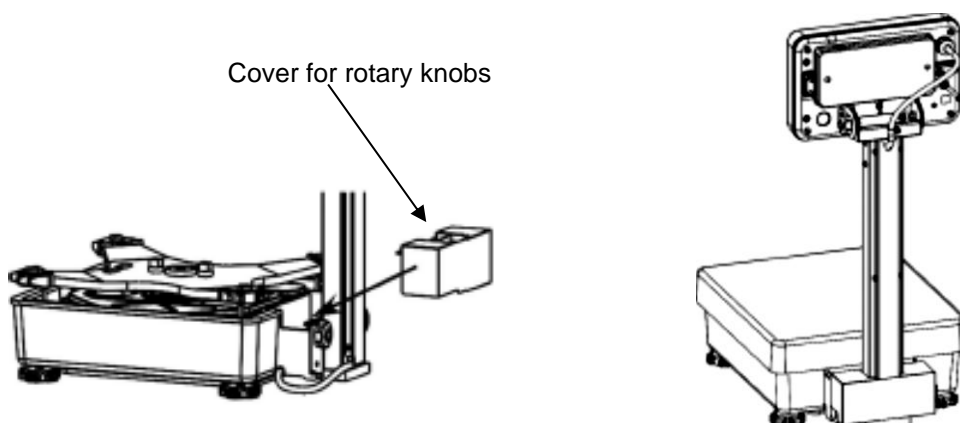

14. Place the weighing plate back on the scale

15. Adjust the angle of the display by turning the display up or down.

**Example picture for mounted stand:**



Never hold the scale by the stand when transporting, only by the platform (fixed part of the weighing unit) of the scale.